

▶ ACCESSORIES

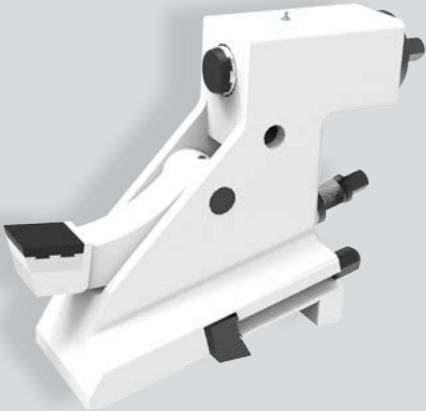

ACCESSORIES / OPTIONS

- ▶ Internal Grinding attachment
- ▶ Internal grinding spindle
- ▶ The grinding spindle with permanent lubrication of roller bearings
- ▶ Air-lifting the tailstock and work-head
- ▶ Tilting wheel dresser or different types of dressers
- ▶ Closed steady rest with different sizes
- ▶ Open steady rest with different sizes
- ▶ Auxiliary rests with different sizes
- ▶ Three-jaw chuck with different sizes
- ▶ Magnetic plate with different sizes
- ▶ Wheel balancing stand
- ▶ Coolant device with tank
- ▶ Frequency regulated main drive
- ▶ Electro-dynamic balance system with power monitor, GAP control, crash control
- ▶ Remote control with 2x handwheel for axis X and Z separately
- ▶ Mist exhaustion
- ▶ Universal solid grinding wheel
- ▶ Probe gauge for longitudinal workpiece positioning MARPOSS or RENISHAW
- ▶ In-process control gauge with pneumatic infeed of measuring head MARPOSS UNIMAR S26, with different range of measured diameters
- ▶ Self-programming in ISO code
- ▶ Teleservis
- ▶ Other accessories upon request



▶ TECHNICAL PARAMETERS

Basic technical parameters of small, medium and large machines «UB 25, 32, 40, 50, 63, 85 CNC»

Working range of machines	Unit	UB 25 CNC	UB 32, 40, 50 CNC	UB 63, 85 CNC
Swing diameter	mm	280	320, 400, 500	630, 850
Distance between centers	mm	630, 1000	1000, 1500, 2000, 3000	2000, 3000, 4000, 5000, 6000
Max. weight of workpiece, between centers / overhung mounting incl. fixture	kg	80/25	500/100	2500/250
Swivelling of Workhead	°	90	90	90
Swivelling of Wheelhead	°	± 45	± 45	+30 / - 10
Swivelling of tables	°	± 8°30', ± 7°30'	°+7°/-5°, +6°/-4°, +5°/-3°, 0	±6°30' / ±5° / ±4° / ± 3° / ±2°
Work-head and Tailstock sleeve taper bore	Morse	4	5	6
Infeed of Wheelhead	m/min	4	4	4
Feed of Table	m/min	6	6	6
max./min. diameter of grinding wheel	mm	400 / 250 x 40 x 127	500 / 380 x 80 x 203	750 / 570 x 100 x 305
Wheel-head motor power	kW	4	11	22



HOL-MONTA
Radiová 1431/2a, 102-00 Praha 10, Czech Republic
Tel.: +420 272 706 555 (6, 7), Fax: +420 272 706 561
e-mail: info@toshostivar.cz, www.toshostivar.cz

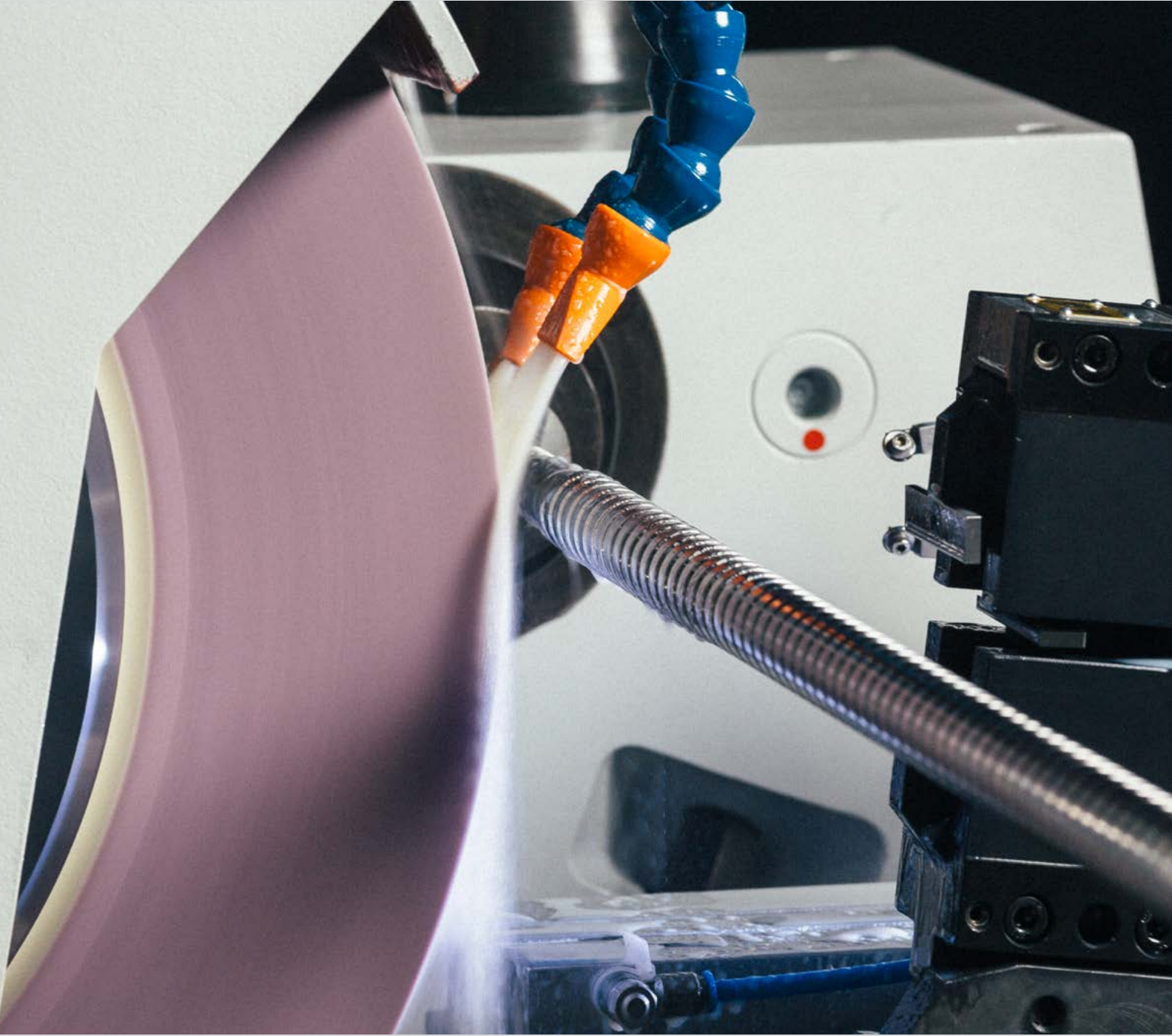

INTRODUCING TOP GRINDING TECHNOLOGY
since 1950

► **TOS HOSTIVAŘ**
MANUFACTURE OF GRINDING TECHNOLOGY SINCE 1950

HOL-Monta, s.r.o. is the owner and successor of the traditional world-class brand TOS HOSTIVAŘ, Czechoslovak and later Czech producer of grinding machines for external and internal grinding of cylindrical surfaces. We continue the rich tradition of this brand, launched in 1950.



► We combine the time-tested construction of TOS HOSTIVAŘ with our own research and come up with new universal and special grinding machines. Production technology using CNC systems and electrical and mechanical components supplied by renowned European manufacturers remain an integral part of our production process.

Our machines feature time-proven construction and technology enhanced by modern elements. Besides the new grinding machines TOS HOSTIVAŘ, series UB 25-32-40-50-63-85-90 CNC, we also offer worldwide supply of original spare parts. We assist with the initial putting of the machine into operation and provide test grinding, warranty and post-warranty service and on-site training for operators.



UNIVERSAL GRINDING MACHINES TOS HOSTIVAŘ, SERIES UB CNC

Our series of grinding machines TOS HOSTIVAŘ can process semi-finished products up to 6,000 mm of length, with a diameter up to 850 mm and weight up to 3,000 kg. The machines are equipped with a full CNC control system Siemens Sinumerik 840 D sl, grinding wheel-head infeed and table feed. The grinding process can be controlled manually or by a fully automatic programme (grinding of more diameters, plunge-cut or horizontal grinding, grinding of convex or concave diameters with automatic adjustment of the grinding wheel).

The workpieces are fixed between centers, overhung or fixed onto a permanent magnetic board. The machines are designed for precise and efficient grinding of single pieces as well as large series of workpieces.

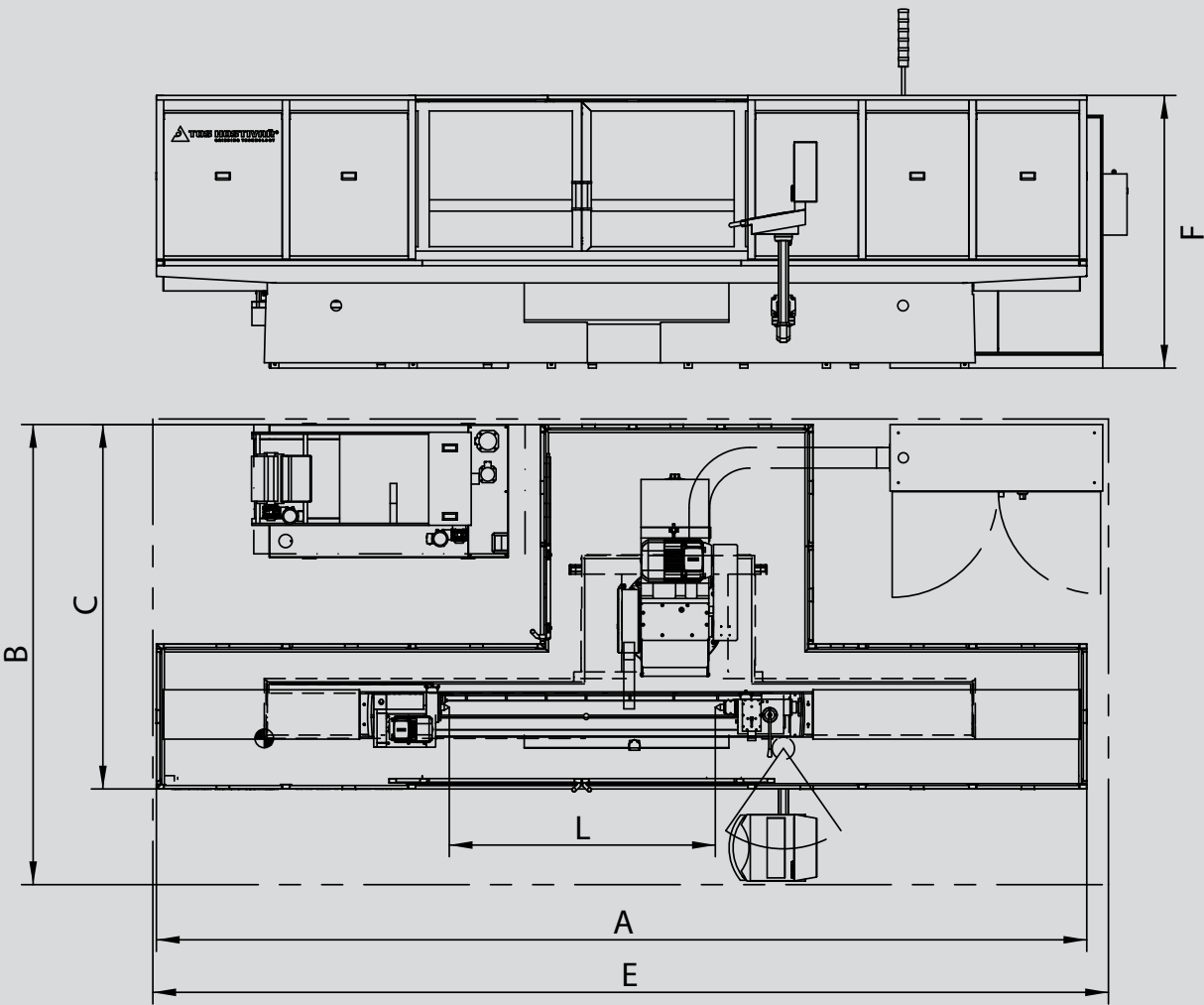

STANDARD MACHINE DIMENSIONS										
mm	UB25 CNC		UB32 CNC , UB40 CNC , UB50 CNC				UB63 CNC , UB85 CNC , UB90 CNC			
L	630	1000	1000	1500	2000	3000	2000	3000	4000	6000
workpiece diameter D	280		320/400/500				630/850/900			
A	3000	3800	5000	6000	7000	8800	8200	10200	12000	15900
B	3000		3500				4100			
C	2000		2700				3200			
E	5600	5600	6200	6200	7000	8800	8200	10200	12000	16000
F	1900		2050				2100			

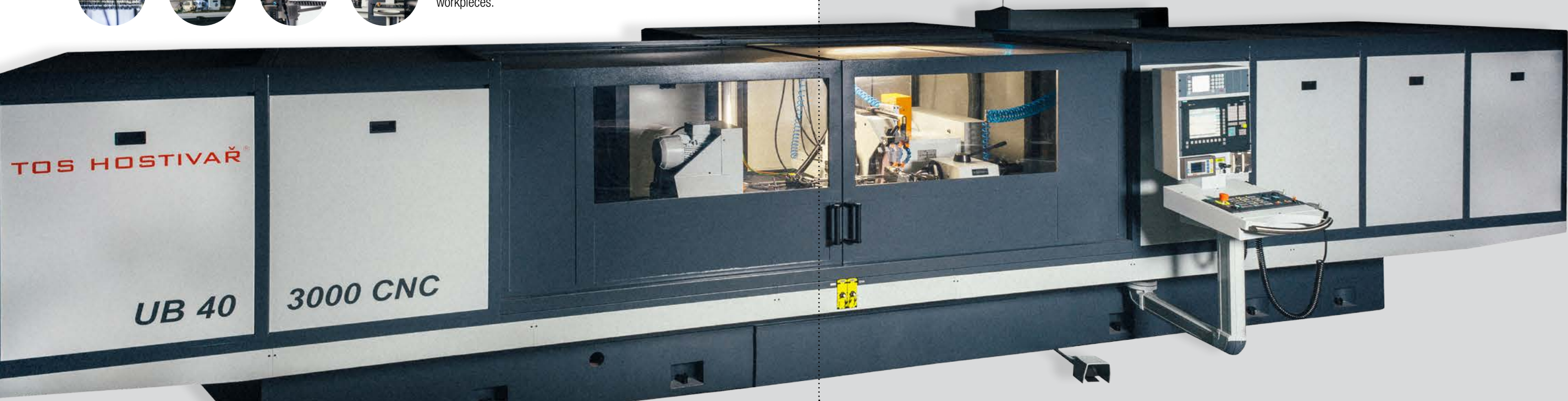

► **WHEEL-HEAD**

The grinding spindle is characterized by rigidity and precision of the grinding spindles.. The spindle is stored in flexible sliding bearings or in roller bearings.

The principal part of the wheel-head advance mechanism is located in the body of the supporting plate, as well as the infeed power screw .A gear box with the servomotor is attached to the rear side of the housing. The servomotor is controlled by linear encoder (Heidenhain).

The plate under the wheel-head can be swivelled.

► **WORK-HEAD**

The work-head consists of the work-head housing and the plate supporting the work-head. This plate is bolted to the upper table by two bolts and nuts. The work-head housing is mounted on the bearing plate and can be swivelled.

The spindle of the work-head is mounted on precision roller bearings. The spindle has taper bore MORSE for fixing the work dead centre.

The driving plate can be removed and fixed onto the plate with chuck, with magnetic clamping plate, or a special clamping fixture can be mounted.

► **TAILSTOCK**

The tailstock is pneumatically fixed on the upper table. A holder for the wheel dresser is fixed on the rear side of the tailstock casing. The Tailstock is controlled either manually by the lever, or pneumatically by electric foot pedal.

The pinole has taper bore MORSE for fixing the work dead/rotation centre.

